

TYPE 7CG

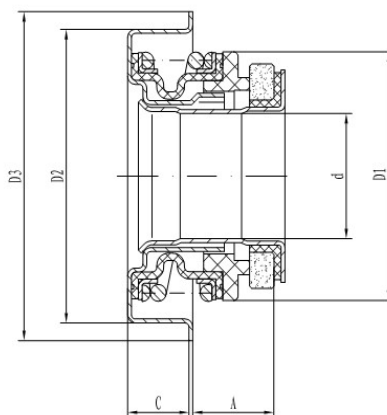

Specification

Temperature : - 35°C ~ 135°C

Pressure : ≤0.3MPa

Speed : φ12≤6500r/min ; φ15≤6200r/min ;
φ16≤6000r/min ;

MATERIAL

Parts & Spring : Stainless Steel

Rubber parts : NBR & HNBR

Stationary Ring : Carbon/Silicon Carbide

Rotary Ring : Ceramic/Silicon Carbide

Model	d	A	C	D1	D2	D3
7CG-3	12	9.1	8	26.5	30	35
7CG-5	12.038	8.9	8	26.5	38.1	43.6
7CG-8	12	7.1	7.5	26.5	30	35
7CG-9	12.038	7.1	8	26.5	30	35
7CG-10TQ	12	7.1	7.5	26.5	30	35
7CG-12	12.038	6.37	9.8	26.5	39.5	43.6
7CG-13	12.038	8.9	8	26.5	47.6	54
7CG-1	15	9.3	8.2	28	36.5	41
7CG-2	15	10.7	8	28	36.5	41
7CG-0	15.918	10.8	8	31.5	36.5	41
7CG-1	15.918	10.8	8	31.5	38.1	43.6
7CG-3	15.918	10.8	8	31.5	38.6	43.6
7CG-4	15.918	10.8	8	31.5	39.5	43.6