

TYPE 7CB

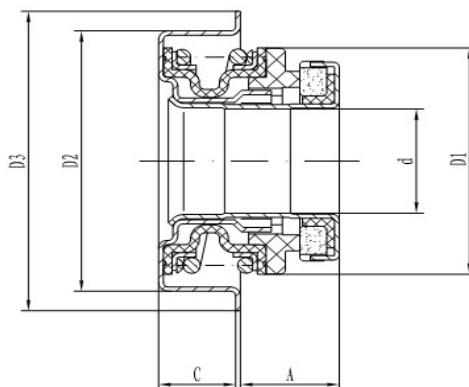

Specification

Temperature : - 35°C ~ 135°C

Pressure : ≤ 0.3 MPa

Speed : $\phi 12 \leq 7200$ r/min ; $\phi 15 \leq 6500$ r/min ;

MATERIAL

Parts & Spring : Stainless Steel

Rubber parts : NBR & HNBR

Stationary Ring : Carbon/Silicon Carbide

Rotary Ring : Silicon Carbide

Model	d	A	C	D1	D2	D3
7CB-0	12	8.4	7.2	26.5	30	35
7CB-3	12	9.3	6.7	26.5	30	35
7CB-7	12	8.4	8	26.5	30	35
7CB-0	15	10.6	8	28	36.5	41