

TYPE 7C/7CA

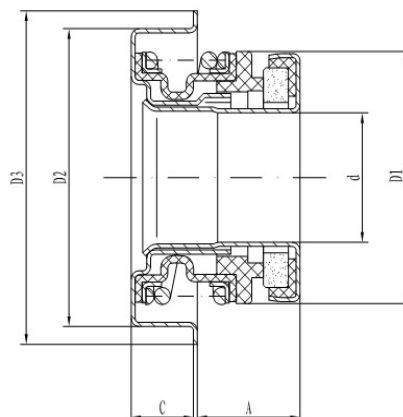

Specification

Temperature : - 35°C ~ 135°C

Pressure : ≤0.3MPa

Speed : φ12≤5200r/min ; φ15≤5000r/min ;

φ16≤4800r/min ; φ17≤4500r/min

φ20≤4000r/min

MATERIAL

Parts & Spring : Stainless Steel

Rubber parts : NBR & HNBR

Stationary Ring : Carbon/Silicon Carbide

Rotary Ring : Ceramic/Silicon Carbide

Model	d	A	C	D1	D2	D3
7C10	10	9.3	8	26.5	30	34.5
7C12-0	12	9.3	8	26.5	30	35
7C12-2	12	9.2	8	26.5	30	35
7C12-2U	12.7	9.2	6.3	26.5	28.5	35
7C12-3	12	7.1	8.5	26.5	30	35
7C12-3U	12	9.3	8	26.5	30	35
7C12-4	12	8.2	7.1	26.5	30	35
7C12-6	12	9.2	6.6	26.5	30	35
7C12-7	12	9.3	8	26.5	32	37
7C12-8	12	9.3	8	26.5	33.6	36.5MIN
7C12-9	12	7.5	7.1	26.5	30	35

Model	d	A	C	D1	D2	D3
7C12-13	12	8.7	7.6	26.5	30	35
7C12-15	12	9.3	8	26.5	36.5	41
7C12-19	12	9.2	8	26.5	38.1	43.6
7C12-23	12	9.2	6	26.5	30	35
7C12-24	12.7	9.2	8	26.5	38.1	43.6
7C12-26	12	8.2	8	26.5	30	35
7C12-27	12	7.2	7.6	26.5	30	35
7C12-28	12	9.3	8	26.5	39.5	43.6
7C12-30	12	8.8	6.3	26.5	30	35
7C12-31	12	9.3	8	26.5	28.6	32MIN
7C13-1	13	8.9	8	26.5	30	35
7C13-2	13	8.9	8	26.5	32	37
7C15-1	15	10.6	8	28.8	36.5	41
7C15-2	15	10.6	8	28.8	30	35
7C16A-0	15.918	10.9	8	31.5	36.5	41
7C16A-4	15.918	10.9	8	31.5	35	41
7C16A-4U	15.918	11.1	6.5	31.5	34.2	39.5
7C16A-5U	15.918	10.9	8	31.5	36.45	41
7C16A-5	15.918	10.9	8	31.5	38.1	43.6
7C16A-6	15.918	11.84	7	31.5	34.2	39.5
7C16A-7	16	10.9	8	31.5	36.5	41
7C16A-11	15.918	10.9	8	31.5	39.5	43.6
7C16A-12	15.918	10.9	8	31.5	33.5	38
7C16A-13	15.918	10.9	8	31.5	55	62
7C16A-16	15.918	10.8	7.2	31.5	36.5	41
7C16A-17	15.918	9.3	7	31.5	34.2	39.5
7C16A-18	15.918	11.8	5.7	31.5	34.2	39.5
7C16A-21	16	11.8	7	31.5	36.5	41
71-2	15.918	10.9	8	31.5	36.55	41
7C17A-0	17	13.6	8	33.5	35	41
7C20A-2	20	11	9.3	37	40	44